

Plat of Survey

of
Lot 27 of Evergreen Estates,
a subdivision located in the Northwest 1/4 of Section 19, Town 3 North,
Range 17 East, Town of LaFayette, Walworth County, Wisconsin.

Surveyed for: **ERA Corner Realty**
5362 State Highway 11
Elkhorn, Wisconsin. 53121

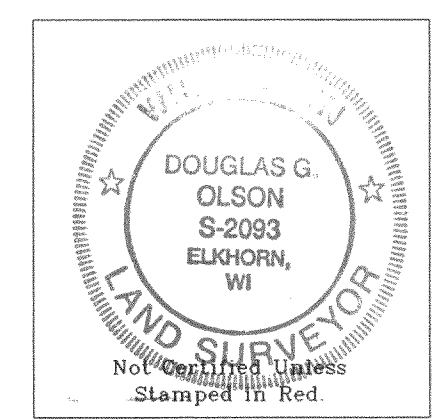
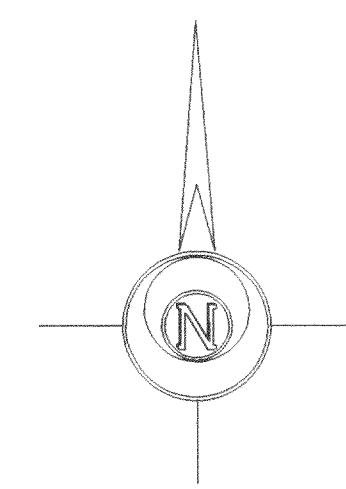

- Notes: 1) This survey plat is not certified unless signed and sealed in red ink.
- 2) This survey is subject to Wisconsin lien laws. This Plat of Survey is the notice of intent to file lien. Lien waiver required.

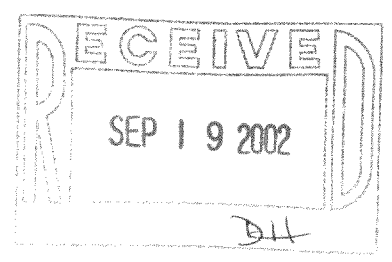

Copyright © 2002 by Jensen & Olson Land Surveying, LLC.

All rights reserved. No part of this survey plat may be reproduced or transmitted in any form by any means - graphic, electronic, or mechanical, including photocopying, tracing, or information storage and retrieval systems - without permission in writing from Douglas G. Olson, Jensen & Olson Land Surveying, LLC.

I hereby certify that I have surveyed the above described property and the map hereon is correct to the best of my professional knowledge and belief and shows the size and location of the property, its exterior boundaries, the location and dimensions of all visible structures thereon, boundary fences, apparent easements and roadways and visible encroachments, if any.

This survey is made for the exclusive use of the present owners of property, and also those who purchase, mortgage or guarantee title thereto, within one year from the date hereof.

Douglas G. Olson
Wisconsin Registered Land Surveyor - 2093

Survey Date: July 12, 2002
Revisions:

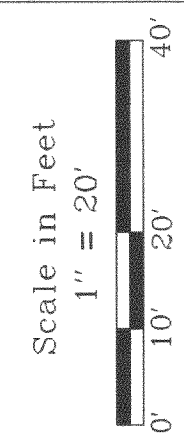

Jensen & Olson Land Surveying, LLC
45 South Wisconsin Street
Elkhorn, Wisconsin. 53121
Telephone (262) 723-3434
Facsimile (262) 723-8044

- Legend**
- Found Iron Pipe
 - Found Iron Rod
 - Set Iron Rod, 3/4" dia.
 - Recorded Information
 - Utility Pedestal
 - Concrete Surface
 - Asphalt Surface

Sheet 1 of 1 Sheets
Job Reference Number
2002.128
2002.128